

Original instructions for the portable pressure equipment

PREBENA MOBILO 300

PREBENA MOBILO 470

PREBENA MOBILO 690

PREBENA MOBILO 900



PREBENA Wilfried Bornemann GmbH & Co. KG
Seestraße 20 – 26, 63679 Schotten, Germany
Tel.: +49 (0) 60 44 / 96 01 – 0, Fax: +49 (0) 60 44 / 96 01 – 820
Email: info@prebena.com
www.prebena.de, www.kartuschen-tausch.de

Preface

These operating instructions will help you with the

- proper use as intended,
- safe and
- beneficial

use of the portable pressure equipment Mobilo 300, Mobilo 470, Mobilo 690 and Mobilo 900, referred to in brief as the pressure equipment.

We assume that every person using this pressure equipment has knowledge of how to handle pneumatic equipment and the applied materials. People who do not have this knowledge must be instructed by an experienced user about how to use the pressure equipment.

Every person

- using,
- cleaning or
- disposing of his pressure equipment

must read and understand these operating instructions.

These operating instructions are considered a part of the product. Always keep them with the pressure equipment. Pass on the operating instructions if you sell the pressure equipment or hand it on in any other manner.

Table of contents

Preface	2
Table of contents	3
Layout characteristics	5
General layout characteristics	5
Safety instruction attributes	6
 Basic safety instructions	7
Proper, intended use	7
Avoid the risk of fatal injuries.....	8
Avoid explosion hazards	8
Avoid risk of injury	8
Avoid damage to the pressure equipment	8
Description	9
Equipment overview and scope of supply	9
Function.....	11
Product features	11
Side and direction specifications	11
Accessories	12
Information on the rating plate.....	12
Preparing the pressure equipment	13
Unpacking the pressure equipment.....	13
Check condition	14
Connecting pressure equipment to the compressed air supply .	15
Using the pressure equipment	19
After operation	23
Disconnect the compressed air supply	23
Transporting and storing the pressure equipment	25
Packing.....	25
Storage	26

Servicing the pressure equipment.....	27
Oiling the pressure equipment.....	28
Filling the compressed air cartridge	29
Testing the compressed air cartridge	29
Repairing faults.....	30
Ordering accessories	32
Reordering compressed air cartridges	32
Ordering other accessories	32
Disposing the pressure equipment	33
Technical data.....	34
MOBILO 300 pressure equipment.....	34
MOBILO 470 pressure equipment.....	34
MOBILO 690 pressure equipment.....	34
MOBILO 900 pressure equipment.....	35
Compressed air cartridge KT-300	35
Compressed air cartridge KT-470	36
Compressed air cartridge KT-690	36
Compressed air cartridge KT-900	36
Manufacturer's address	37
Guarantee	38
Index.....	39

Layout characteristics

General layout characteristics

Various elements in the operating instructions are marked with specific layout characteristics. This allows you to easily distinguish whether it is

normal text,

- lists or
- ▶ process steps

that you are reading about.

-  These instructions contain additional information such as specific information on the cost-effective use of the pressure equipment.

Safety instruction attributes

All safety instructions in these operating instructions are based on the same pattern. On the left you will find a symbol indicating the type of danger. To the right of that you will see a signal word which identifies the severity of the danger. Under that you will find a description of the source of danger and instructions on how to avoid this danger.



DANGER

Warnings with the word **DANGER** indicate hazards with an immediate impending risk of serious or even fatal injuries.



WARNING

Warnings with the word **WARNING** warn of hazards that can lead to potentially serious or even fatal injuries.



CAUTION

Warnings with the word **CAUTION** warn of hazards that can lead to potentially slight to moderate injuries, property or environmental damage.



Basic safety instructions

Observe and follow all the warnings and instructions in these operating instructions and those on the pressure equipment when using the pressure equipment. The enclosed Declaration of Conformity is an element of these operating instructions

Proper, intended use

The pressure equipment is used for portable accumulation and reduction of the stored pressure at a low operating pressure for supplying the tapping points. The pressure equipment is intended for do-it-yourselfers and craftsmen who need compressed air for various purposes. Proper intended use also includes compliance with the accident prevention regulations and the statutory regulations and standards in force at the place of use. Use in any other way is not considered proper intended use and can result in material damage or even personal injury.

Unauthorised use constitutes in particular operation

- by persons without the necessary knowledge in the use of pressure equipment and the materials used,
- of pressure equipment modified without the authorisation of the manufacturer,
- with accessories other than those stipulated in these operating instructions,
- connected to compressed air sources not listed in these operating instructions,

PREBENA WILFRIED BORNEMANN GMBH & CO. KG accepts no liability for any damage or injuries resulting from any such improper or unintended use.

Avoid the risk of fatal injuries

- Do not allow children to play with packaging films - risk of suffocation.

Avoid explosion hazards

- Do not use the pressure equipment in areas with an explosion hazard.
- Never operate the pressure equipment with oxygen or other explosive gases or gas mixtures.
- Do not expose the compressed air cartridge to temperatures over 100°C.

Avoid risk of injury

- Store the pressure equipment out of the reach of children and other unauthorised persons.
- Always disconnect the pressure equipment from the compressed air cartridge before transporting.

Avoid damage to the pressure equipment

- Never open the pressure equipment. Always leave repairs to qualified specialists.
- Do not use the pressure equipment if it has been dropped or is damaged. Have it inspected by qualified specialists before putting it into use again.

Description

Equipment overview and scope of supply

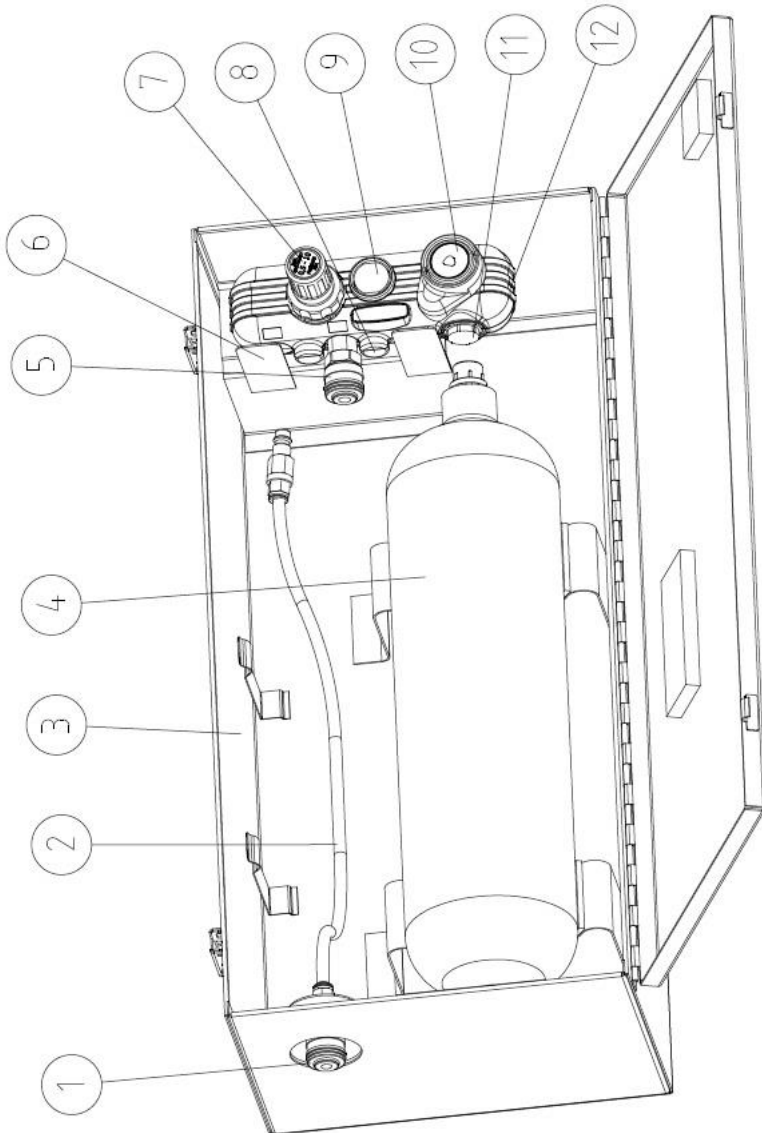

Description

No.	Explanation
1	Tapping point for operation in the metal transport case (ID 7.2)
2	Connection for tapping points (ID 7.2)
3	Metal transport case
4	Compressed air cartridge KT-300, KT-470, KT-690, KT-900
5	Tapping point for operation on carrier bag (ID 7.2)
6	Manometer (pressure gauge) for the operating pressure
7	Control for the operating pressure
8	Safety valve for the operating pressure with firing at 11 bar
9	Holder
10	Pressure gauge for the pressure of the compressed air cartridge (filling level indicator)
11	Safety valve compressed air cartridge with firing at 21 bar
12	Port for the compressed air cartridge with stoppers
–	Spiral hose for connection to the sampling points (ID 7.2)
–	Declaration of Conformity for Mobilo 300, Mobilo 470, Mobilo 690 and Mobilo 900 (not illustrated)
–	Declaration of Conformity for KT-300, KT-470, KT-690, KT-900 (not illustrated)
–	Operating instructions for cartridges KT-300, KT-470, KT-690, KT-900 (not illustrated)

Function

The pressure equipment reduces the stored pressure to a lower operating pressure for supplying the tapping points. The compressed air cartridges KT-300, KT-470, KT-690 and KT-900 are used as the pressure source. Excess pressure is bled off through the pressure relief valve.

You can set the operating pressure by controlling the discharge pressure.

Product features

The pressure equipment has the following features:

- Operation is possible in the case or with a carrier bag (fitted on body).

Side and direction specifications

The direction specification for the operating pressure controller refers to looking at the top of the pressure gauge for the discharge pressure.

Accessories

The following accessories are available for the pressure equipment:

- Compressed air cartridges KT-300, KT-470, KT-690 and KT-900
- Compressor for compressed air cartridge PKT-FILLMASTER 350 and PKT-FILLMASTER 400 (not included in scope of supply)
- Spiral hose with 6.5 mm inner diameter and 2 m working length
- Compressed air hose set (not included in scope of supply)
- Hose reel (not included in scope of supply)

Information on the rating plate

The rating plate is glued to the rear of the pressure controller. It contains the following information:

- Company name and country of origin
- Type designation of the pressure equipment
- The maximum admissible working pressure
- The CE symbol (the product conforms to the standards listed in the included Declaration of Conformity)
- Serial number
- Discharge output

Preparing the pressure equipment

Unpacking the pressure equipment

- ▶ Remove the pressure equipment from the packaging.
- ▶ Remove all packaging materials, such as plastic films, filler material and the cardboard box.



WARNING

Do not allow children to play with plastic packaging films. Risk of suffocation!

- ▶ Do not allow children to play with plastic packaging films.
- ▶ Keep packing materials out of the reach of children.

-
- ▶ Save the packaging material for later use.

Check condition



WARNING

There is a risk of injury when using damaged pressure equipment and if the accessories are not correctly fastened.

- ▶ Check the condition of the pressure equipment before each use.
 - ▶ Use pressure equipment in perfect condition only.
-
- ▶ Check the following points in particular:
 - The hoses lines must be undamaged.
 - All parts of the pressure equipment and all accessories must be securely attached.
 - The safety devices must not be blocked or otherwise impaired in their function.
 - No parts of the pressure equipment or the accessories may show visible signs of damage, such as scratches or dents.
- ⓘ Scratches on the housing paint do not constitute damage.
- ▶ Do not connect damaged pressure equipment to a compressed air supply.
 - ▶ Have damaged pressure equipment repaired by qualified specialists before putting it into operation.

Connecting pressure equipment to the compressed air supply

The pressure equipment is connected to a compressed air cartridge (included in the scope of delivery).

The admissible working pressure of the pressure equipment is 10 bar. If the admissible operating pressure is exceeded, the dial on the pressure gauge (6.) for the operating pressure moves into the red range.

This can occur under the following conditions:

- If both safety valves are defective and
- you have connected the pressure equipment to an unsuitable compressed air cartridge.



WARNING

Risk of explosion if the maximum operating pressure is exceeded.

- ▶ If this happens, immediately disconnect the compressed air supply from the pressure equipment.
-

Attach compressed air cartridge

- ▶ Screw the stopper out of the connecting thread for the compressed air cartridge.
- ▶ Screw the seal cap off the compressed air cartridge.

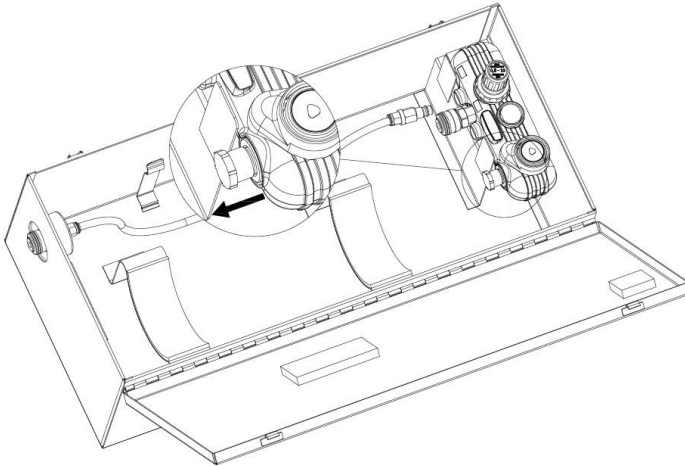

- ▶ Check the fitting and the connecting thread for the compressed air cartridge for foreign matter and soiling.
- ▶ Clean the fitting and connecting thread, if necessary.
- ▶ Check the condition of the pressure equipment (see page 14).



WARNING

Operating with unsuitable compressed air cartridges can cause damage on the pressure equipment.

- ▶ Operate the pressure equipment only with compressed air cartridge of type KT-300, KT-470, KT-690 and KT-900.
-

- ▶ Screw the compressed air cartridge hand-tight into the thread of fitting (12).

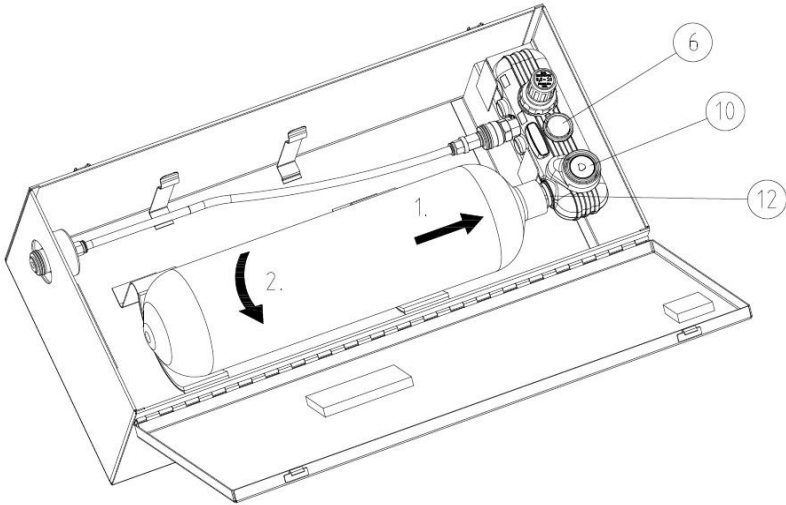

The pressure gauge (10.) on the fitting for the compressed air cartridge now shows the pressure currently prevailing in the cartridge. The pressure equipment is ready for operation when the pointer of the pressure gauge (10.) is in the green part of the scale.

The pressure gauge (6.) for the operating pressure displays the current operating pressure.

If you use an unsuitable compressed air cartridge and if both safety valves are defective, the pressure in this cartridge can exceed the maximum admissible operating pressure of the pressure equipment. In this case the pointer of the pressure gauge (6.) indicates an operating pressure of more than 10 bar.



WARNING

Risk of explosion if the maximum operating pressure is exceeded.

- ▶ Immediately disconnect the compressed air cartridge from the pressure equipment.

When the pointer of the pressure gauge (10.) on the fitting for the compressed air cartridge is in the red zone of the scale, the pressure in the compressed air cartridge is no longer sufficient to operate the pressure equipment.

- ▶ In this case replace the compressed air cartridge with a full compressed air cartridge.
- i** You can refill the compressed air cartridge using the PKT-FILLMASTER 350 and PKT-FILLMASTER 400 compressors, which are available as an accessory. You can also purchase a full compressed air cartridge in exchange for an empty cartridge from your dealer.

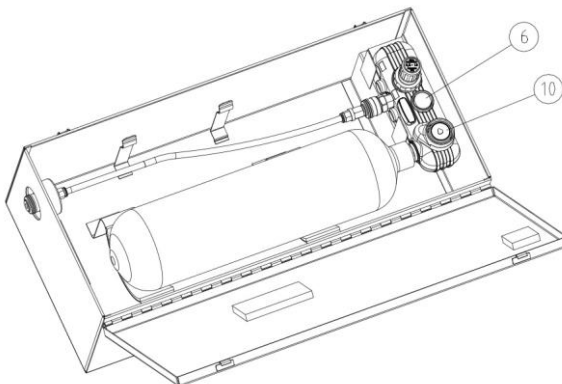

Using the pressure equipment

You can operate the pressure equipment in the metal transport case or the carrier bag directly on your body. Both alternatives facilitate efficient and effective operation of pressure equipment independent of a stationary source of compressed air.

Operation in the metal transport case

To operate the pressure equipment in the metal transport case, proceed as follows:

- ▶ Place the transport case in a horizontal position with the lid facing upwards. Open the transport case and the latch for the lid.
- ▶ Connect the compressed air supply to the pressure equipment as described on page 16.
- ▶ Push the fitting of the connection hose (2.) onto the quick coupler of the pressure equipment tapping point (5.) until it engages audibly.

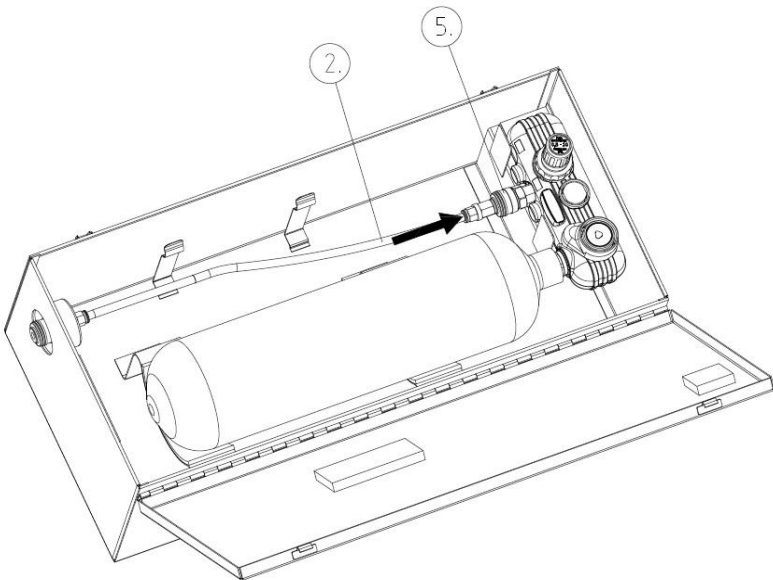

- ▶ Push the fitting of the compressed air hose (13.) onto the quick coupler of the transport case tapping point (1.) until it engages audibly.
- ▶ Set the desired operating pressure for the operating pressure (7.) on the controller (see page 23).
- ▶ You can now run various compressed air tools on the compressed air hose quick coupler (14.).

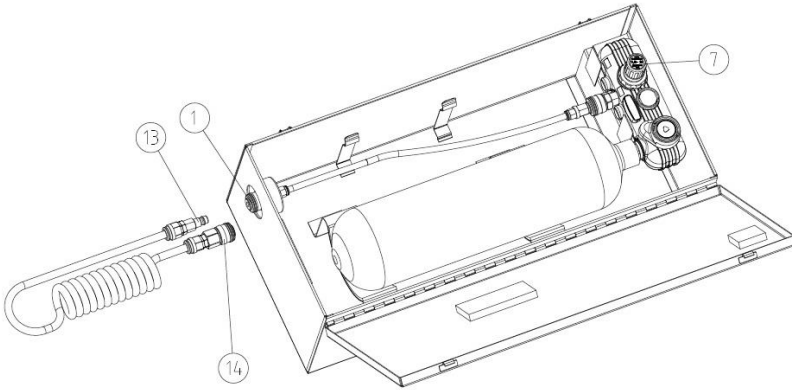

i Please carefully read the manual of the involved accessory for technical attributes and the instructions for correct use.

Controlling operating pressure

You can control the operating pressure on the operating pressure controller (7.).

i Set the operating pressure such that the operating pressure desired for the application is just obtained. This offers the following advantages:

- You save energy (compressed air),
- You reduce the noise level, and
- You reduce the wear on the accessory unit.

To adjust the operating pressure, proceed as follows:

- ▶ Hold the pressure equipment so that you can easily read the pressure gauge (6.) for the operating pressure.
- ▶ Pull the operating pressure controller (7) up and away from the pressure gauge.
- ▶ Turn the operating pressure controller until the pressure gauge dial (6.) stands at about 5 bar:

The average operating pressure is now set.

Adjust the desired operating pressure as below:

- ▶ To increase the operating pressure, turn the operating pressure controller (7.) clockwise.
- ▶ To decrease the operating pressure, turn the operating pressure controller (7.) anticlockwise.

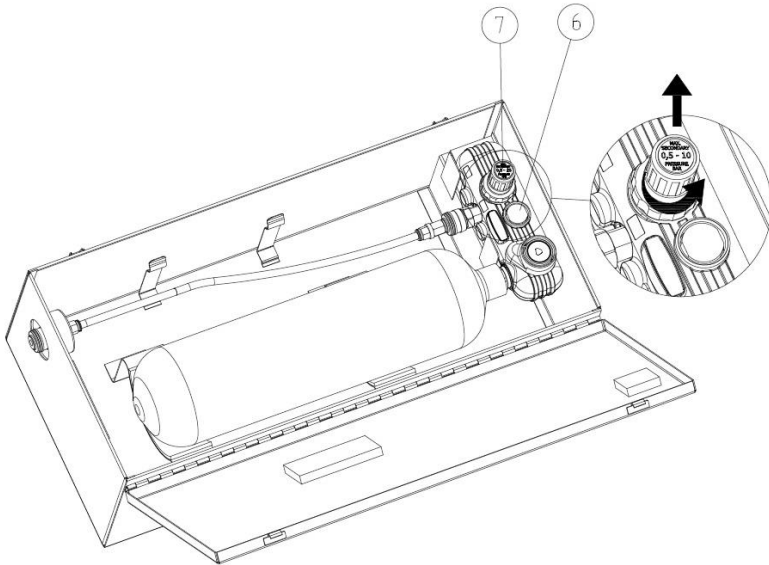

- i** A quarter turn of the operating pressure controller changes the operating pressure by roughly 0.5 bar.
- ▶ While doing so, observe the indicator on the pressure gauge for the operating pressure (6)..
 - ▶ Push the operating pressure controller (7.) towards the pressure gauge.
 - ▶ Check the operating pressure controller in the corresponding accessory manual.
 - ▶ Repeat these steps until the desired operating pressure is set.

After operation

After use or prior to prolonged shut-downs, perform the steps described below.

Disconnect the compressed air supply

Remove compressed air cartridge

- ▶ Unscrew the compressed air cartridge from the thread of the fitting (12.).

The compressed air contained in the pressure equipment escapes audibly.

- ▶ Screw the stoppers into the fitting thread.
- ▶ Screw the seal cap onto the compressed-air cartridge.
- ▶ Store the compressed air cartridge protected against impacts and dropping in the supplied transport case.

 You can refill the compressed air cartridge using the PKT-FILLMASTER 350 and PKT-FILLMASTER 400 compressors, which are available as an accessory. You can also purchase a full compressed air cartridge in exchange for an empty cartridge from your dealer.

Disconnect compressed air hose XE "Release quick coupler"

- ▶ Press the quick coupler of the tapping point (5.) towards the pressure equipment.

The quick coupler is now released.

- ▶ Pull the connection hose (2.) off the tapping point (5.) on the pressure equipment.
- ▶ Press the quick coupler of the tapping point (1.) towards the pressure equipment.

The quick coupler is now released.

- ▶ Pull the compressed air hose off the tapping point (1.) on the pressure equipment.

Transporting and storing the pressure equipment

Packing

Pack up the pressure equipment before storage and after use.

Carry out the following preparatory steps:

- ▶ Disconnect the pressure equipment from the compressed air supply (see page 23).
- ▶ Allow the pressure to be completely relieved from the pressure equipment.
- ▶ If necessary, clean the compressed air connections to remove any foreign matter and soiling.
- ▶ Close the compressed air fittings with suitable plugs.
- ▶ Put the pressure equipment and the carrying bag in the transport case as illustrated.

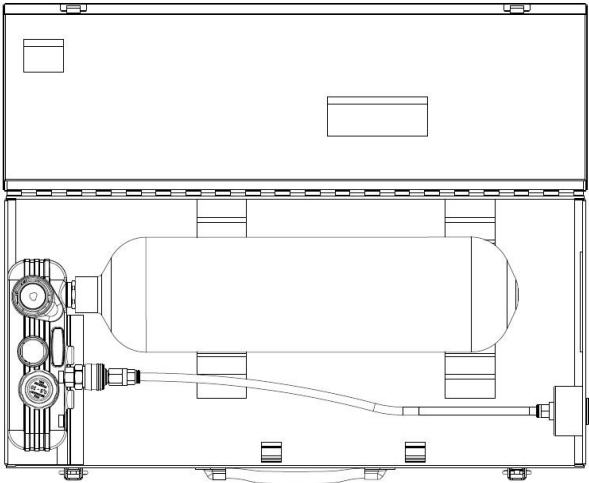

- ▶ Close the transport case and the latch for the lid.

Storage

- ▶ Oil all metal parts of the pressure equipment thinly with PREBENA special nailer oil.
- ▶ Pack the pressure equipment in the transport case.
- ▶ Store the pressure equipment at room temperature in a dry place protected from dust.

Servicing the pressure equipment

The pressure equipment may only be serviced by persons with the required knowledge, skills and experience. All work not described here must be carried out by the manufacturer's aftersales service or at the manufacturer.

Cleaning housing and external surfaces



CAUTION

Unsuitable cleaning agents can cause damage to the pressure equipment or the accessories.

- ▶ Clean only with a dry or slightly damp cloth or a cloth dampened with a mild soap solution.
-

Slight soiling

- ▶ Wipe off the pressure equipment housing with a dry cloth.
- ▶ Oil all metal parts of the pressure equipment thinly with PREBENA special nailer oil.

Severe soiling

- ▶ Wipe off the pressure equipment housing with a cloth dampened slightly with a mild soap solution.
- ▶ Then wipe off the housing with a cloth dampened slightly with tap water.
- ▶ Finally wipe the housing dry with a soft, dry cloth.
- ▶ Oil all metal parts of the pressure equipment thinly with PREBENA special nailer oil.

Oiling the pressure equipment



CAUTION

Insufficient lubrication or the use of the wrong lubricants can cause damage to the pressure equipment.

- ▶ Use only PREBENA special nailer oil.
 - ▶ Fill the lubricating oil into the compressed air cartridge port.
-

- ▶ Pour two to five drops of PREBENA special nailer oil directly into the port for the compressed air cartridge every day before starting work.
-



CAUTION

Danger of environmental pollution if the lubricating oil is spilled.

- ▶ Absorb spilled oil with a binding agent.
 - ▶ Wipe up absorbed oil with a cloth.
 - ▶ Dispose of the cloths in accordance with the statutory regulations in force at the place of use.
-

Filling the compressed air cartridge

Empty KT-300, KT-470, KT-690 and KT-900 compressed air cartridges may only be filled with the PKT-FILLMASTER 350 and PKT-FILLMASTER 400 compressors, which are available as an accessory.

- ▶ Comply the operating manual of the compressor during this.

Testing the compressed air cartridge



WARNING

Danger of explosion through untested compressed air cartridges.

- ▶ Use solely tested compressed air cartridges.
-

The KT-300, KT-470, KT-690 and KT-900 compressed air cartridges must pass a pressure test at PREBENA every five years. This test must be documented in the intended box on the compressed air cartridge label. If you charge the compressed air cartridge with the PKT-FILLMASTER compressor yourself, you must send the cartridge to PREBENA for pressure testing. Otherwise, this test is performed while the compressed air cartridges are filled at PREBENA.

- ▶ Check the date of the last periodical test on the rating plate.
- ▶ Comply the cartridge operating manual while doing so.

If the date five years ago or older, proceed as below:

- ▶ Pack the cartridge in a robust shipping carton.
- ▶ Send the cartridge to PREBENA for testing.
- ▶ Use solely properly tested compressed air cartridges.

Repairing faults



WARNING

Operation of damaged or malfunctioning pressure equipment can result in serious or even fatal injuries.

- ▶ In case of a fault, immediately disconnect pressure equipment from the compressed air supply.
- ▶ Use the pressure equipment again only after the fault has been repaired.



CAUTION

The pressure equipment may be damaged if repaired by unauthorised persons.

- ▶ Let the manufacturer perform all repairs to the pressure equipment.

The following chart shows possible malfunctions and the necessary measures.

Symptom	Possible cause	Corrective measure
Pressure equipment loses air.	The fastening screws are loose.	▶ Tighten fastening screws.
	A seal is defective.	▶ Contact Service (see page 37).
Operating pressure too high.	Pressure reduction valve or safety valve defective.	<ul style="list-style-type: none">▶ Immediately disconnect the pressure equipment from the compressed air supply (see page Fehler! Textmarke nicht definiert.).▶ Contact Service (see page 37).

Symptom	Possible cause	Corrective measure
<p>Operating pressure too high (air escaping audibly at the safety valve (11.) for operation with compressed air cartridge).</p>	<p>Pressure equipment is damaged or pressure in the compressed air cartridge is too high.</p>	<ul style="list-style-type: none"> ▶ Immediately disconnect the cartridge from the pressure equipment (see page 16). ▶ Apply the correct operating pressure to the cartridge (see page 16). <p>If the problem continues to exist:</p> <ul style="list-style-type: none"> ▶ Disconnect cartridge from pressure equipment. ▶ Contact Service (see page 37).
<p>Operating pressure too high (air escaping audibly at safety valve (8.) for the operating pressure).</p>	<p>Operating pressure set too high or pressure equipment damaged.</p>	<ul style="list-style-type: none"> ▶ Reduce operating pressure (see page 21). <p>If the problem continues to exist:</p> <ul style="list-style-type: none"> ▶ Immediately disconnect the cartridge from the pressure equipment (see page 16). ▶ Contact Service (see page 37).

If the malfunction continues to persist, contact your dealer or the manufacturer (see page 37).

Ordering accessories

You can reorder accessories from the manufacturer (see page 37).

Reordering compressed air cartridges

You can purchase full KT-300, KT-470, KT-690 und KT-900 compressed air cartridges in exchange for empty cartridges from your dealer.

Ordering other accessories

Name	Order number
PREBENA special nailer oil	Z200.10
PKT-FILLMASTER 350 Compressor	PKT-FILLMASTER 350
PKT-FILLMASTER 400 Compressor	PKT-FILLMASTER 400
Spiral hose with 9 mm inner diameter, 12 mm outer diameter, working length 4 m, extended length 7.5 m	Z160.12
Compressed air hose set with 9 mm inner diameter, 15 mm outer diameter, extended length 10.0 m	Z200.20
Compressed air hose drum with inner diameter 8 cm, outer diameter 12 cm, for a hose length of 30 m	Z180.00
Spiral hose with 6.5 mm inner diameter, 10 mm outer diameter and 2 m working length	98863901

Disposing the pressure equipment



CAUTION

Environmental damage if incorrectly disposed.

- ▶ Clean the pressure equipment before disposal.
 - ▶ Comply with applicable regulations for oil disposal.
-



Never throw the pressure equipment or parts of it into normal domestic refuse. Ask your city or municipal authorities about facilities for recycling or for environmentally safe and proper disposal of the pressure equipment.

You can obtain information about the materials used in the pressure equipment from the manufacturer.

Technical data

MOBILO 300 pressure equipment

Dimensions with case (L × W × H):	600 x 290 x 195+ mm
Weight, with transport case:	11.0 kg
Operating pressure:	0.5–10 bar
Maximum operating pressure:	10 bar
Max. discharge output:	220 l/min
Safety-valve set pressure: (Operating pressure)	11 bar
Safety-valve set pressure: (Compressed air cartridge)	21 bar
Operating temperatures:	–5 to +45°C
Storage/transport temperature:	Room temperature

MOBILO 470 pressure equipment

Dimensions with case (L × W × H):	600 x 290 x 195+ mm
Weight, with transport case:	12.6 kg
Operating pressure:	0.5–10 bar
Maximum operating pressure:	10 bar
Max. discharge output:	220 l/min
Safety-valve set pressure: (Operating pressure)	11 bar
Safety-valve set pressure: (Compressed air cartridge)	21 bar
Operating temperatures:	–5 to +45°C
Storage/transport temperature:	Room temperature

MOBILO 690 pressure equipment

Dimensions with case (L × W × H):	675 x 310 x 235+ mm
Weight, with transport case:	15.5 kg
Operating pressure:	0.5–10 bar
Maximum operating pressure:	10 bar
Max. discharge output:	220 l/min

Safety-valve set pressure: (Operating pressure)	11 bar
Safety-valve set pressure: (Compressed air cartridge)	21 bar
Operating temperatures:	-5 to +45°C
Storage/transport temperature:	Room temperature

MOBILO 900 pressure equipment

Dimensions with case (L × W × H):	675 x 310 x 235+ mm
Weight, with transport case:	17.5 kg
Operating pressure:	0.5–10 bar
Maximum operating pressure:	10 bar
Max. discharge output:	220 l/min
Safety-valve set pressure: (Operating pressure)	11 bar
Safety-valve set pressure: (Compressed air cartridge)	21 bar
Operating temperatures:	-5 to +45°C
Storage/transport temperature:	Room temperature

Compressed air cartridge KT-300

Length:	465 mm
Diameter:	115 mm
Weight, empty cartridge:	2.0 kg
Weight, filled cartridge:	3.06 kg
Contents:	3.0 l compressed air
Maximum container air pressure:	300 bar
Operating temperature:	-5 to +45°C
Storage/transport temperature:	Room temperature, maximum 60°C
Maximum service life:	15 years from manufacture

Compressed air cartridge KT-470

Length:	505 mm
Diameter:	140 mm
Weight, empty cartridge:	2.9 kg
Weight, filled cartridge:	4.54 kg
Contents:	4.7 l compressed air
Maximum container air pressure:	300 bar
Operating temperature:	-5 to +45°C
Storage/transport temperature:	Room temperature, maximum 60°C
Maximum service life:	15 years from manufacture

Compressed air cartridge KT-690

Length:	540 mm
Diameter:	160 mm
Weight, empty cartridge:	3.9 kg
Weight, filled cartridge:	6.22 kg
Contents:	6.9 l compressed air
Maximum container air pressure:	300 bar
Operating temperature:	-5 to +45°C
Storage/transport temperature:	Room temperature, maximum 60°C
Maximum service life:	15 years from manufacture

Compressed air cartridge KT-900

Length:	575 mm
Diameter:	175 mm
Weight, empty cartridge:	5.0 kg
Weight, filled cartridge:	8.1 kg
Contents:	9.0 l compressed air
Maximum container air pressure:	300 bar
Operating temperature:	-5 to +45°C
Storage/transport temperature:	Room temperature, maximum 60°C
Maximum service life:	15 years from manufacture

Manufacturer's address

PREBENA

Wilfried Bornemann GmbH & Co. KG

Befestigungstechnik

Seestraße 20–26

D-63679 Schotten

Telephone: +49 (0) 60 44 / 96 01-0

Telefax: +49 (0) 60 44 / 96 01-820

Email: info@prebena.de

Homepage: www.prebena.de
www.kartuschen-tausch.de

Guarantee

PREBENA provides a 1 year guarantee on the stated product starting from the date of sale under the following guarantee terms. PREBENA guarantees free of charge repair of faults attributable to material or manufacturing faults. Malfunctions or damage caused by improper use are not covered by the free of charge guarantee.

The guarantee does not cover wearing parts such as O-rings, etc. It shall be at the discretion of PREBENA to fulfil the guarantee by replacement of the faulty part or by the supply of a new product. No further claims will be accepted.

In order to claim under the guarantee, the completed guarantee form with dealer's stamp and date of sale or an invoice containing the dates and information required on the guarantee form must be enclosed with the product.

Shipment: The product to which the claim relates must be packed carefully in order to avoid damage during transport and sent postage paid to PREBENA.



Guarantee form

Model name:

Date of purchase:

Dealer:

(Stamp)

Index

A

Accessories

- Compressed air cartridges 32
- Description 12
- Nailer oil 32
- Order numbers 32
- Ordering 32
- PKT-FILLMASTER Compressor 32

After operation

- Disconnect from the compressed air supply 23

C

Care

- Cleaning external surfaces 27
- Oiling 28

Check

- Compressed air cartridge 29
- Condition 14
- Pressure gauge for compressed air cartridge 17
- Pressure gauge for operating pressure 15

Check condition

- hose line 14
- Safety devices 14
- Visible damage 14

Cleaning

- Housing and external surfaces 27
- Severe soiling 27

Slight soiling 27

Cleaning external surfaces 27

Cleaning the housing 27

Compressed air cartridge

- attachment 16
- Check 29
- Compressor 32
- Connection 17
- Disconnect 23
- Fill 29
- Pressure gauge 17
- Reorder 32
- Technical data 35, 36

Compressed air hose

- Release quick coupler 24

Compressed air supply

- Connection 15
- Disconnect 23

Connection

- Compressed air cartridge 17

Control

- Operating pressure 19, 21

D

Description

- Accessories 12
- Features 11
- Function 11
- Rating plate 12
- Scope of supply 10
- Side and direction specifications 11

Disposal 33

F

Features 11

Fill

Compressed air cartridge
29

Function 11

G

Guarantee 38

L

Layout attributes

General text 5
Safety instructions 6

M

Malfunctions

Repair 30
Service 31

Manufacturer's address 37

Maximum operating pressure 34, 35

O

Oiling 28

Operating pressure

Economic setting 21
Maximum 15, 34, 35
Pressure gauge 15
Reading 21, 22
Set 19, 21

Operation

After operation 23
Operation 19
Preparation 13
Repairing faults 30

Set operating pressure 19,
21

P

Packing 25

Prebena 37

Preparation

Attaching compressed air
cartridge 16
Check condition 14
Connect to compressed air
supply 15
Unpacking 13

Pressure equipment

Disposal 33
Oiling 28
Operation 19
Pack in transport case 25
Packing 25
Preparation 13
Service 27
Storage 25
Technical data 34, 35
Unpacking 13

Pressure gauge

Compressed air cartridge
17
Operating pressure 15
Reading the operating
pressure 21, 22

Proper, intended use 7

Putting into storage 25

R

Rating plate 12

Remove severe soiling 27

Remove slight soiling 27

S**Safety devices**

Check condition 14

Safety instructions

Basic instructions 7

Layout attributes 6

Proper, intended use 7

Service 27, 37

Fill compressed air
cartridge 29

Testing the compressed air
cartridge 29

Set

Operating pressure 19, 21

**Side and direction
specifications 11****Storage 25****T****Technical data**

Compressed air cartridge
KT-300 35

Compressed air cartridge
KT-470 36

Compressed air cartridge
KT-690 36

Compressed air cartridge
KT-900 36

MOBILO 300 pressure
equipment 34

MOBILO 470 pressure
equipment 34

MOBILO 690 pressure
equipment 34

MOBILO 900 pressure
equipment 35

Transport case 25**Troubleshooting 30****U****Unpacking 13****W****Working posture 8**



PREBENA Wilfried Bornemann GmbH & Co. KG
Seestraße 20 – 26, 63679 Schotten, Germany
Tel.: +49 (0) 60 44 / 96 01 – 0, Fax: +49 (0) 60 44 / 96 01 – 820
Email: info@prebena.com
www.prebena.de, www.kartuschen-tausch.de